



Lexham Gardens, W8

Lexham Gardens, W8

A vast, three double bedroom duplex apartment with a private terrace leading to a 40ft garden. This apartment has been fully refurbished to the highest standards.

Lexham Gardens is one of the most desirable street in Kensington, moments away from High Street Kensington and Holland Park.

Council Tax Band: G
Deposit: £12,300

Three Double Bedrooms, Three Bathrooms, Newly Refurbished, Private Terrace, High Ceilings & Wood Floors

Asking price: £2,050

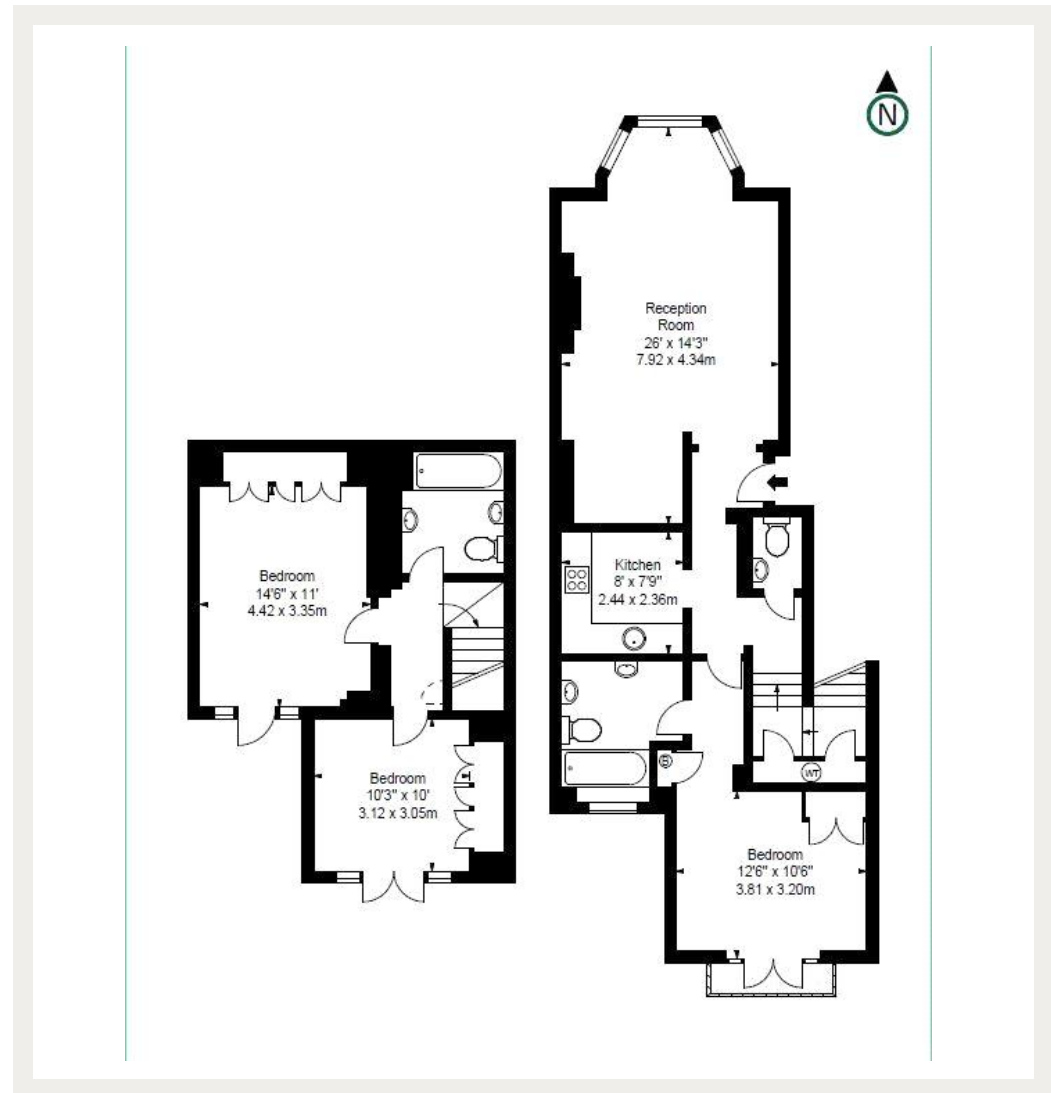

020 7096 9476

contact@landstones.co.uk

Whilst every effort is made to ensure the accuracy of these details, it should be noted that the measurements are approximate only. Floorplans are for representation purposes only and prepared according to the RICS Code of Measuring Practice by our floorplan provider. Therefore, the layout of doors, windows and rooms are approximate and should be regarded as such by any prospective tenant.