



Eardley Crescent, SW5

Eardley Crescent, SW5

Landstones are proud to bring to the market this top floor split level three bedroom apartment with access to its own breath-taking private panoramic roof terrace.

The apartment features an open plan kitchen living room that is flooded with bright natural light from the large picture windows to the front. The large reception area has ample room for both hosting dinner parties and snug TV watching evenings.

Three large double bedrooms provide space for the whole family or a versatile apartment for rental investors looking at sharing couples.

With plenty of room to put your own unique stamp on the property this apartment is a wonderful project to turn into a spectacular home.

Eardley Crescent is ideally located between West Brompton and Earl's Court tube stations, also moments away from the many shops, bars and restaurants of Earl's Court and Chelsea.

Council Tax Band: F (Kensington and Chelsea)
Tenure: Share of Freehold

Private Rooftop, Three Double Bedrooms, Top Floor Flat, Wooden Floors

Asking price: £1,350,000

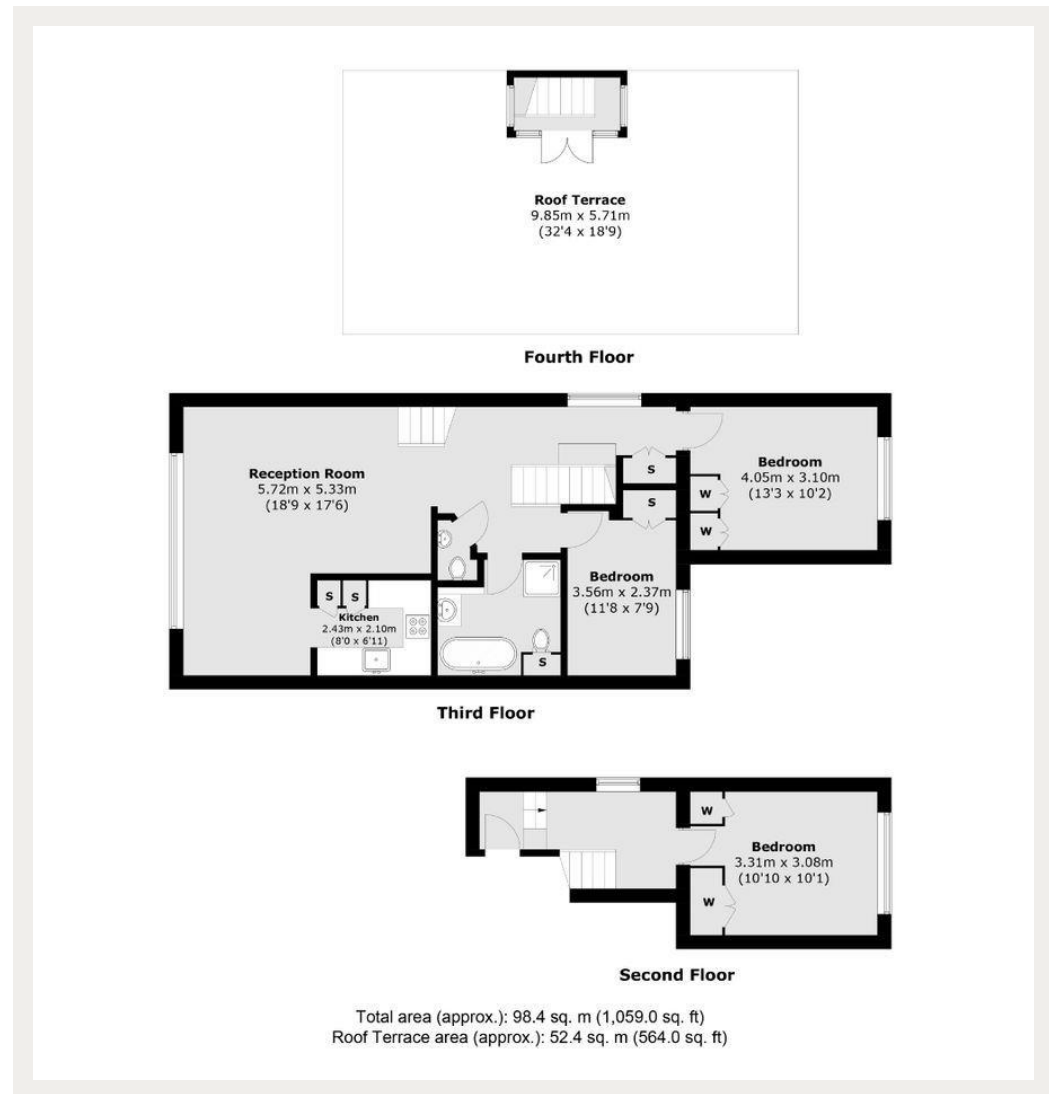

Whilst every effort is made to ensure the accuracy of these details, it should be noted that the measurements are approximate only. Floorplans are for representation purposes only and prepared according to the RICS Code of Measuring Practice by our floorplan provider. Therefore, the layout of doors, windows and rooms are approximate and should be regarded as such by any prospective purchaser. Any internal photographs are intended as a guide only and it should not be assumed that any of the furniture/fittings are included in any sale. Where shown, details of lease, ground rent and service charge are provided by the vendor and their accuracy cannot be guaranteed, as the information may not have been verified and further checks should be made either through your solicitor/conveyance. Where appliances, including central heating, are mentioned, it cannot be assumed that they are in working order, as they have not been tested. Please also note that wiring, plumbing and drains have not been checked.

020 7096 9476

contact@landstones.co.uk